



Where there is **SLOKY**,  
there is quality.



**SLOKY**<sup>®</sup>

Rremarkably  
Simple Tool



**Preset Torque  
&  
Screwdriver**



## Easy Customization

SLOKY® torque tools can be easily customized to accommodate your needs for specific torque values. Helping you accomplish accurate torque controls.



## Tool Holder & Cutting Tool

The SLOKY® torque screwdriver allows technicians to apply factory-defined torque values onto screws to guarantee no over-tightening.



Torque range : 0.1~18.0 Nm

## Micro-Technology

SLOKY® torque tools are carefully designed with microtechnology in mind. The ergonomically designed patterned handle is good for better grip and allows for quick fastening. Ideal for micro-mechanics to assemble, adjust, and repair small parts.

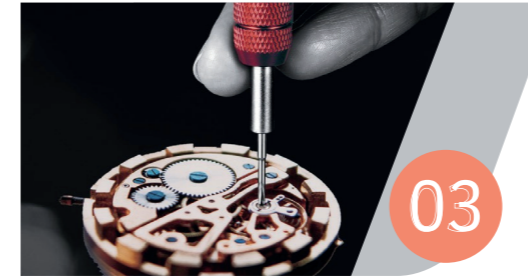

Torque range : 0.8cNm~0.1Nm

## Medical

Medical technology demands exceptional quality with every screw in medical devices. SLOKY® torque tools upheld these standards by preventing the risk of over- or under-tightening.

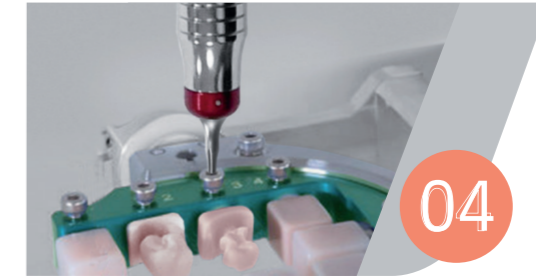

Torque range : 0.1~6.0Nm

# Remarkably Simple Tool

### Features :

- No over or under-tightening
- "Click" sound
- Precise torque accuracy
- Color-coded
- Patented design

### Specifications :

- Torque range: 0.1~18.0 Nm
- Connecting and driving portion can be customized.

### Electronic Devices

Using SLOKY® torque screwdriver for fastening is an excellent choice to standardize procedures to reduce human error.



### Construction

Using SLOKY® torque screwdriver prevents possible damage during installation. The humanized design of the screwdrivers of limiting the torque will ensure smooth processing during installation.



### Sports

Modern sports use lightweight components, which require specific tension and tightening for screws to ensure safety during any activities. SLOKY tools met these requirements with exceptional stability and reliability.



### Fastener & Hardware

SLOKY® torque tools provide a precise controlled fastening to delicate components. Its high level of customization allow various combinations for specialized kits based on needs.



#### No Over-Tightening !

Torque remains the same value once the demand torque setting is met. No increase, No drop.



#### A "Click" sound !

When the demand torque setting is met.



#### 30% Reversible system.

30% higher torque for loosening.



#### Fasten and loosen!

When using SLOKY, there is no need to change tools for fastening or loosening.





Select Nm  
S

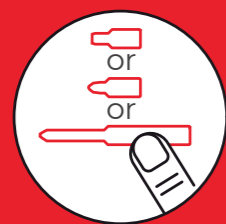

Length of bit  
L



Ok to go  
O



Keep tightening  
K



Yes it's done  
Y

Remarkably  
Simple Tool

Customized  
Adapter  
Design



## Interchangeability

- All parts are color-coded and modularized with ease of interchangeability in mind.
- Universal connections allowed customizations.
- All parts are available for purchase individually.



## Durability

- SLOKY meets above and beyond the ISO standard of 5,000 turns with 20,000 turns capable.



## Reliability

- Rely on the provided torque accuracy within  $\pm 10\%$ .



Interchangeable



# About Us

“SLOKY®” comes from the word “SOLO KEY” in the Taiwanese dialect, which means “Screw It In”. The unique patented adapters play the most important role in the torque screwdriver system. Along with the precision and torque controls, the uniquely featured adapters allowed full customization with various handles and bits. SLOKY® take pride in providing interchangeability, durability, and reliability. The greatest advantage of “No over-tightening” is important in the industrial field, and in many other fields. Precise control prevents damages of screws, tools and equipment. Ease of use as well as an interchangeable functions allowed bits of different shapes and dimension for max customizations.

Bits



Adapters



Service



Innovation

Patents in multi-country :  
Taiwan, Japan, USA, Germany

TW / M439546  
CN / ZL201220320077.3 · US / 8833211  
DE / 102012005885.3 · JP / 3181981



# SLOKY®

## Interchangeable System



# Contents

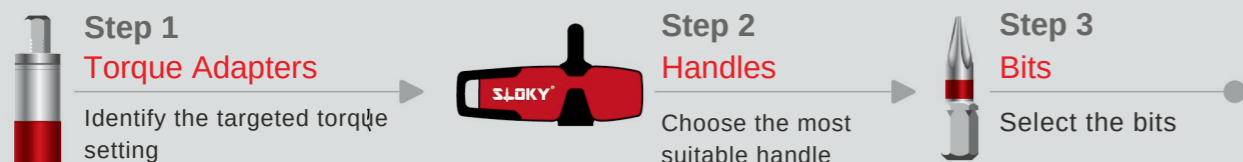

Unlimited Applications. Remarkably Simple Torque Tools.  
 One system with 3 Handles, 12 Torque, TX/IP/HEX, 25(1")/50(2")/75mm(3") bits. Total of 324 combos !!  
 Every parts, bits, handles, and torque adapters are interchangeable.  
 Custom design serve beyond the 324 combos!

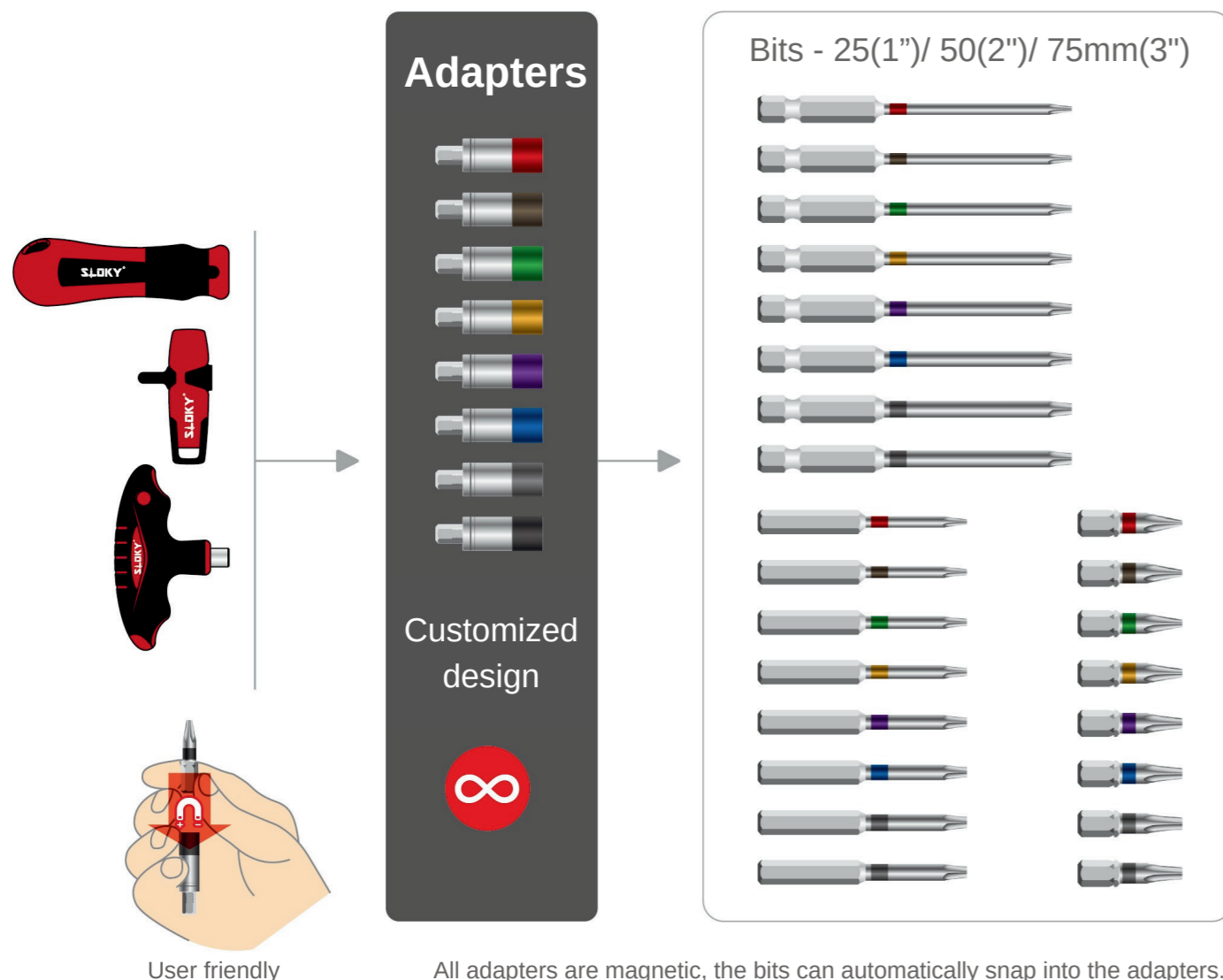

User friendly

All adapters are magnetic, the bits can automatically snap into the adapters.

Adapters	Icon	Options	Range	Page
Preset Adapter			5.3~53.1In-lb	08
Small Adapter			0.9~6.2In-lb	08
Extend Adapter			57.5~159.3In-lb	09
Mini Adapter			0.9~6.2In-lb	10
Quick Change Adapter			17.7~44.3In-lb	11
Multi Adapter			17.7、26.6、35.4、44.3、53.1In-lb	11
Special Inquiry				12

Handle	Icon	Options	Image	Page
Flag-shaped T				13
Straight				
Heavy-Duty T				

Bits	Icon	Options	Page
TORX®			16
TORX PLUS®			17
HEXAGON			18

Kits	Icon	Kit Name	Page
		Pro Station	19
		Twin Set	22
		Pro Set	20
		Single Set	23
		Smart Set	21
		Single Set	24

Info	Icon	Content	Page
		Accessory / User guide / Digital media	25



# Adapters

✓ According to ISO 6789 life test

A "Click" sound when the targeted torque setting is reached. 20,000 clicks guaranteed !

Reversible system 30% higher torque for loosening



## Principles

Patented designed adapters allowed "No over tightening".

According to the DIN EN ISO 6789 life test, 20,000 clicks are guaranteed.

When the targeted torque setting is met, continuous tightening no longer increase the torque screws.

"No over-tightening" adapters are created from the non-return ratchet torque socket.

- Torque range is possible from 0.9 In-lb-159.3In-lb / 0.1Nm-18Nm

## Preset Torque Adapters

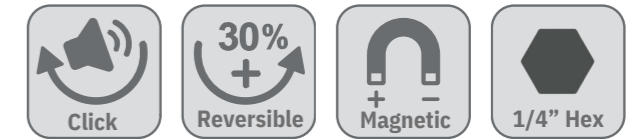

- Torque Range: 5.3-53.1In-lb / 0.6-6.0Nm
- Adapter diameter:12mm
- Torque Accuracy : ±10%

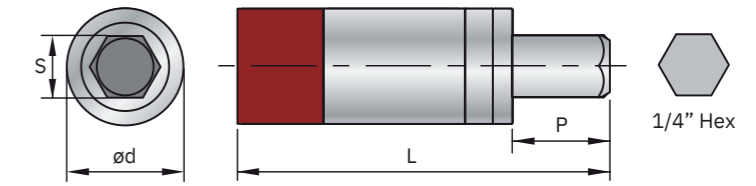

### Standard

Parts No.	Nm	In-lb	S (mm)	Ød (mm)	L (mm)	P (mm)	QTY	N.W.	Packaging Illustration
STS-ADT-06-06	0.6	5.3	DIN 3126 1/4" Hex (6.35mm)	12	38.3	10	3 pcs	80g	
STS-ADT-07-09	0.9	8.0							
STS-ADT-08-12	1.2	10.6							
STS-ADT-09-14	1.4	12.4							
STS-ADT-10-20	2.0	17.7							
STS-ADT-15-30	3.0	26.6							
STS-ADT-20-50	5.0	44.3							
STS-ADT-25-55	5.5	48.7							
STS-ADT-C-04	0.4	3.5	DIN 3126 1/4" Hex (6.35mm)	12	38.3	10	3 pcs	80g	
STS-ADT-C-05	0.5	4.4							
STS-ADT-C-11	1.1	9.7							
STS-ADT-C-25	2.5	22.1							
STS-ADT-C-38	3.8	33.6							
STS-ADT-C-40	4.0	35.4							
STS-ADT-C-45	4.5	39.8							
STS-ADT-C-60	6.0	53.1							

## Small Torque Adapters

### CS Series

Parts No.	Nm	In-lb	S (mm)	Ød (mm)	L (mm)	P (mm)	QTY	N.W.	Packaging Illustration
STS-ADT-CS-01	0.1	0.9	DIN 3126 1/4" Hex (6.35mm)	10	34.5	10	3 pcs	60g	
STS-ADT-CS-02	0.2	1.8							
STS-ADT-CS-03	0.3	2.7							
STS-ADT-CS-04	0.4	3.5							
STS-ADT-CS-05	0.5	4.4							
STS-ADT-CS-06	0.6	5.3							
STS-ADT-CS-07	0.7	6.2							

Preset Torque Adapters



# Extend Torque Adapters

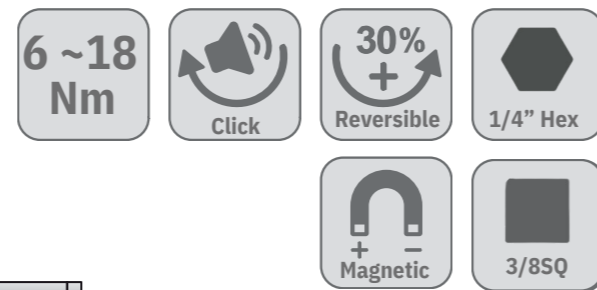

- Torque range : 57.5-159.3In-lb / 6.5-18Nm
- Various types of connecting and driving design
- Torque Accuracy : ±10%

## CX Series

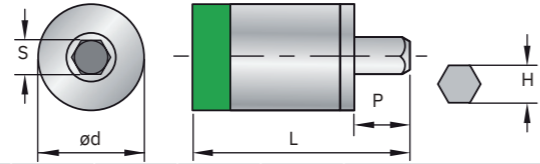

Parts No.	Nm	In-lb	S (mm)	ød (mm)	L (mm)	P (mm)	QTY	N.W.	Packaging Illustration
STS-ADT-CX-65	6.5	57.5	DIN 3126 1/4" Hex	20	43.5	10	1pc	80g	
STS-ADT-CX-70	7.0	62.0							
STS-ADT-CX-75	7.5	66.4							
STS-ADT-CX-78	7.8	69.0							
STS-ADT-CX-80	8.0	70.8							
STS-ADT-CX-95	9.5	85.8							
STS-ADT-CX-100	10.0	88.5							
STS-ADT-CX-120	12.0	106.2							

## CXS Series

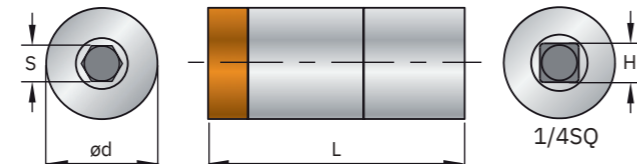

Parts No.	Nm	In-lb	S (mm)	ød (mm)	L (mm)	P (mm)	QTY	N.W.	Packaging Illustration
STS-ADT-CXS-80	8.0	70.8	DIN 3126 1/4" Hex	20	44.5	--	1 pc	100g	
STS-ADT-CXS-100	10.0	88.5							
STS-ADT-CXS-120	12.0	106.2							
STS-ADT-CXS-150	15.0	132.8							
STS-ADT-CXS-180	18.0	159.3							

## CSS Series

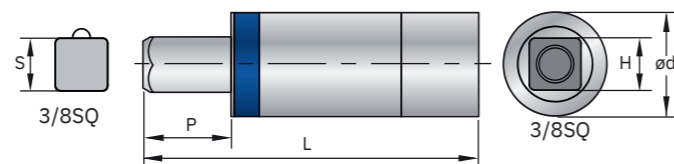

Parts No.	Nm	In-lb	S (mm)	ød (mm)	L (mm)	P (mm)	QTY	N.W.	Packaging Illustration
STS-ADT-CSS-80	8.0	70.8	DIN 3122/ DIN 3123 3/8" Square	20	53.0	12	1 pc	90g	
STS-ADT-CSS-100	10.0	88.5							
STS-ADT-CSS-120	12.0	106.2							
STS-ADT-CSS-150	15.0	132.8							
STS-ADT-CSS-180	18.0	159.3							

# Mini Torque Adapters

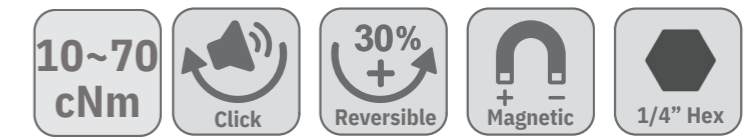

- Torque range : 0.9-6.2In-lb / 0.9-6.2In-lb
- Adapter diameter: 8mm
- Torque Accuracy : ±10%

## Applications

- Fine Cutting Tool
- Communication Devices
- Consumer Electronics
- Drones/UAV
- Smart Phones
- Printed Circuit Boards
- Watches .....

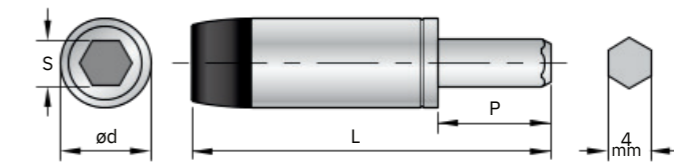

Parts No.	cNm	In-lb	S (mm)	ød (mm)	L (mm)	P (mm)	QTY	N.W.	Packaging Illustration
STS-ADT-CM-01	10	0.9	4mm Hex	8	32	10	3 pcs	35g	
STS-ADT-CM-02	20	1.8							
STS-ADT-CM-03	30	2.7							
STS-ADT-CM-04	40	3.5							
STS-ADT-CM-05	50	4.4							
STS-ADT-CM-06	60	5.3							
STS-ADT-CM-07	70	6.2							

## Transform normal screwdriver to torque screwdriver

- SLOKY mini torque adapter fits almost any kinds of the 4mm bits and handle with Ø4 mm in the market.

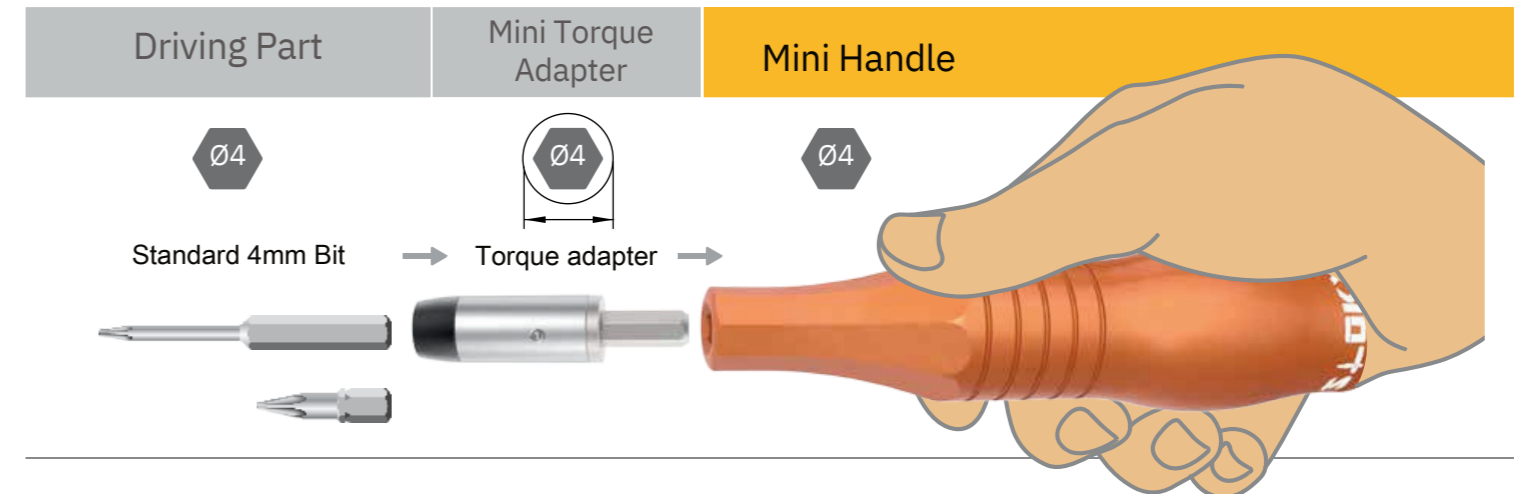



# Quick Change Torque Adapters

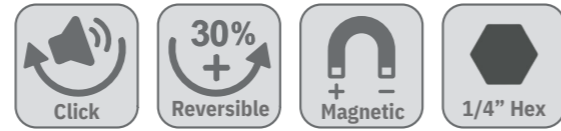

## Power Tool Adapters

- Quick change design for multiple applications.
- Speed limits below 250 r.p.m.
- Further tighten manually with a slight force to reach the required torque.
- Shorten tightening job for long screws or multiple screws with identical torque controls.
- Torque Accuracy :  $\pm 10\%$

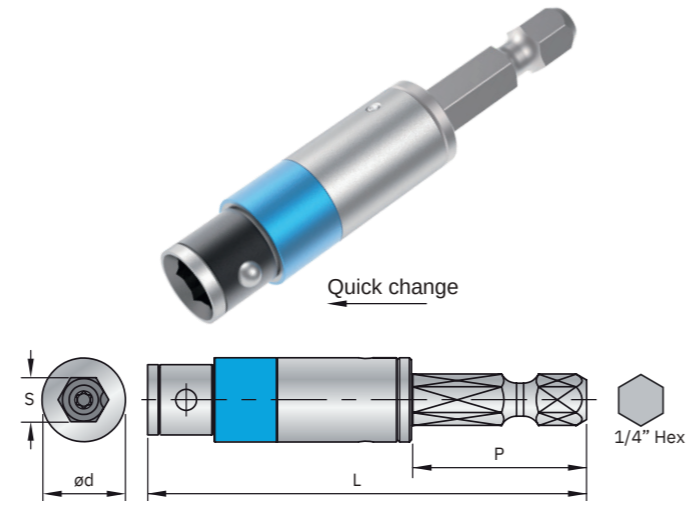

Parts No.	Nm	In-lb	S (mm)	$\varnothing d$ (mm)	L (mm)	P (mm)	QTY	N.W.
STS-ADT-CP-2.0	2.0	17.7	DIN 3126 1/4" Hex	12	62.7	25	1 pc	35g
STS-ADT-CP-3.0	3.0	26.6						
STS-ADT-CP-4.5	4.5	39.8						
STS-ADT-CP-5.0	5.0	44.3						

# Multi-Torque Adapters



## 5-in-1

- Visually define torque value on adapter.
- No more over or under tightening on screws.
- Ease of use for multiple torque requirements.
- Not for loosening.

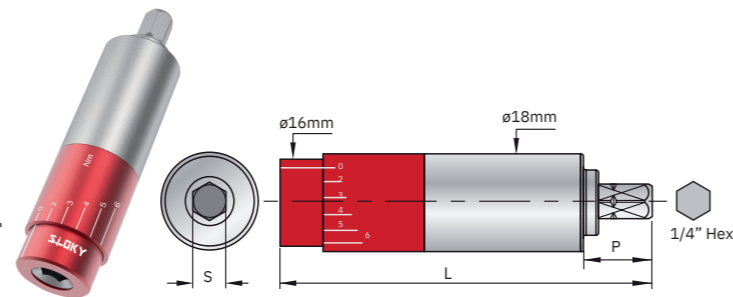

Parts No.	Nm	In-lb	S (mm)	$\varnothing d$ (mm)	L (mm)	P (mm)	QTY	N.W.
STS-ADT-IL-J1	2.0	17.7	DIN 3126 1/4" Hex	18	68.8	10	1 pc	105g
	3.0	26.6						
STS-ADT-NM-J1	4.0	35.4						
	5.0	44.3						
	6.0	53.1						

\* Other torque range is available on request, max. torque 10Nm.

# Special Inquiry

Please send your inquiry to [info@slokyusa.com](mailto:info@slokyusa.com)

## Company

## Phone/Email

Adapter Diameter	$\varnothing D$ mm	
	Torque Range	Fig
$\varnothing 8\text{mm}$	0.1 ~ 0.7 Nm	1, 2
$\varnothing 10\text{mm}$	0.9 ~ 6.2 Nm	
$\varnothing 12\text{mm}$	0.6 ~ 6.0 Nm 5.3 ~ 53.1 Nm	3, 4
$\varnothing 20\text{mm}$	6.0 ~ 18.0 Nm 53.1 ~ 159.3 Nm	
Specification (Fig)	<input type="checkbox"/> 1 <input type="checkbox"/> 2 <input type="checkbox"/> 3 <input type="checkbox"/> 4 <input type="checkbox"/> 5 <input type="checkbox"/> 6 <input type="checkbox"/> 7	
Specification	<input type="checkbox"/> Newton meter <input type="checkbox"/> Inch-pound	
Torque Tolerance	<input type="checkbox"/> $\pm 6\%$ <input type="checkbox"/> $\pm 10\%$	
L Overall Length	mm	
Connecting Part		
DIN ISO Standard		
Type	<input type="checkbox"/> C type <input type="checkbox"/> E type <input type="checkbox"/> Other	
H (Connecting Head)	<input type="checkbox"/> Male <input type="checkbox"/> Female <input type="checkbox"/> Hex <input type="checkbox"/> Square	
Size	mm/inch E.g. 1/4", 3/8", 1/2".....	
P (Connecting Length)	mm	
Driving Part		
DIN ISO Standard		
S (Driving Head)	<input type="checkbox"/> Male <input type="checkbox"/> Female <input type="checkbox"/> Hex <input type="checkbox"/> Square	
Depth Overall Length	mm	
Size	mm/inch E.g. 1/4", 3/8", 1/2".....	
Quick Change	<input type="checkbox"/> Yes <input type="checkbox"/> No	

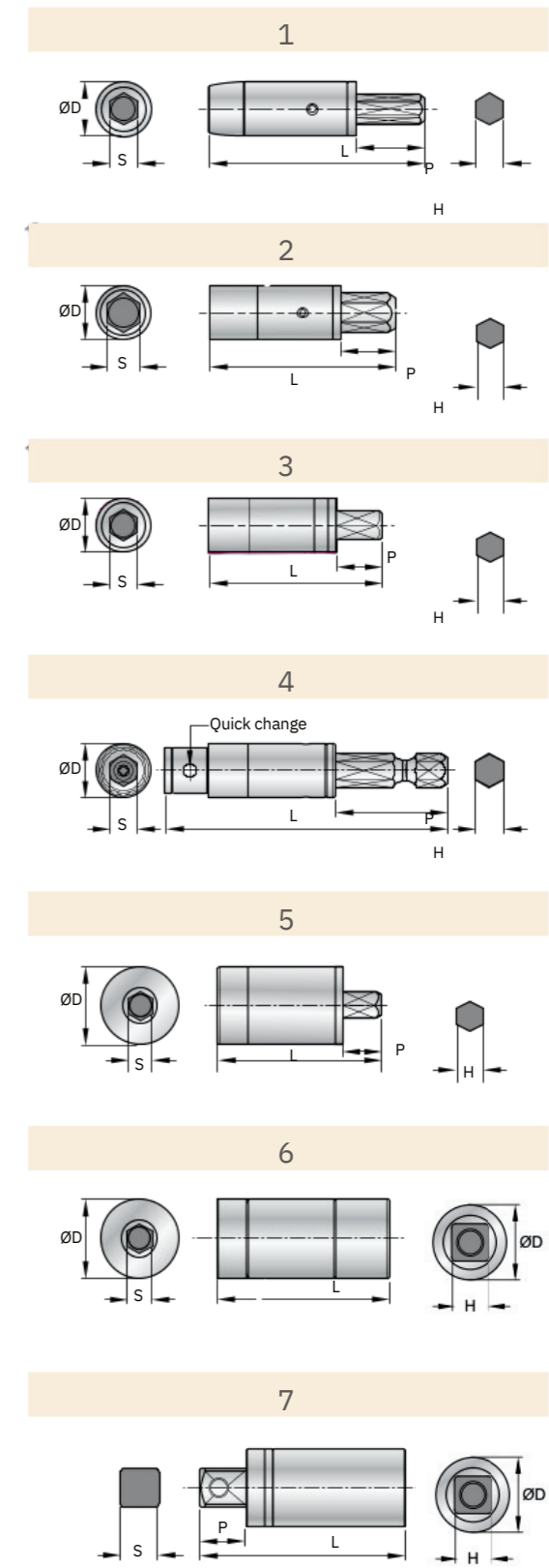



# Handles



Use same torque screwdriver to tighten and loosen your screws.

✓ Ergonomic design of the handles

## Features

We offer **3** different types of handles to cover all torque adapters. The soft zones are comfortable to hold and flexible. Effortlessly tighten and loosen screws even in higher torque range.

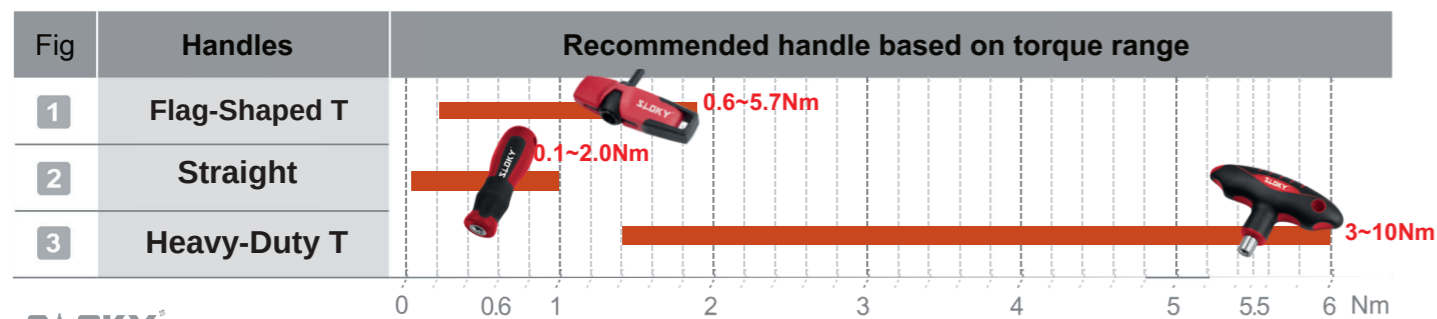

### Flag-shaped T Handles

- Universal type for holding in multiple ways.
- Ergonomically design for ease of use and efficiency.

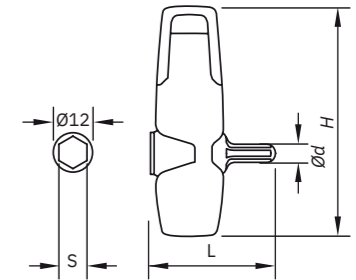

Fig	Parts No.	Suit For Torque	Color	S (mm)	L (mm)	H (mm)	Ød (mm)	N.W.
1	STS-TX-LT	0.6~5.7 Nm	Red	6.35 (1/4")	37.5	70.7	5	25g
	STS-IP-LT		Blue					

### Straight Handles

- Comfortability, accuracy and efficiency for tightening and loosening

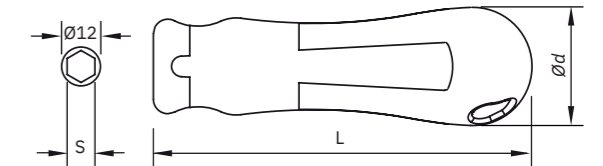

Fig	Parts No.	Suit For Torque	Color	S (mm)	L (mm)	Ød (mm)	N.W.
2	STS-TX-HD-S	0.1~2.0 Nm	Red	6.35 (1/4")	104	32.5	50g
	STS-IP-HD-S		Blue				

Large size HD handle(4-1/2") is available. Part No. **STS-TX-HD-L** OR **STS-IP-HD-L**.

### Heavy-Duty T Handles

- Lightweight handle, with comfortable soft zones, designed for higher torque.

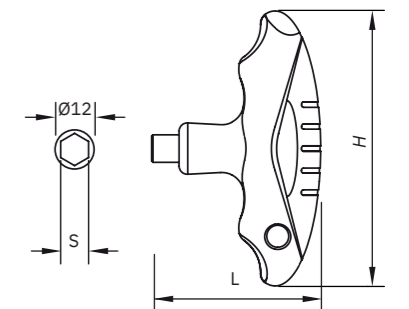

Fig	Parts No.	Suit For Torque	Color	S (mm)	L (mm)	Ød (mm)	N.W.
3	STS-TX-ST	3.0~10.0 Nm	Red	6.35 (1/4")	65	100	60g
	STS-IP-ST		Blue				



# Bits



✓ Tools created from ideas



TX20 / 20IP / H4  
TX25 / 25IP / H5

TX15 / 15IP / H3

TX10 / 10IP / H2.5

TX9 / 9IP

TX8 / 8IP / H2

TX7 / 7IP

TX6 / 6IP / H1.5

## Color-coded

No mistake! Both the adapters and the bits are color-coded. Selecting the suitable torques and bits are as simple as building bricks, fast and visual.



Quick exchange  
Magnetic design allow convenient and quick exchange of the bits.

## Bits-TORX®

Hardness : HRC 58° ~ 60°  
Material : High alloy steel

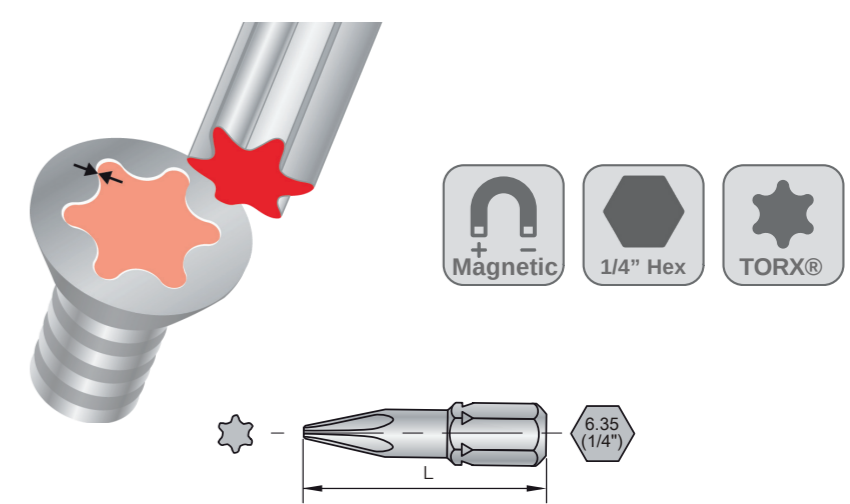

### 25mm(1")Bits for TORX®

Standard : DIN3126 – C6.3 (1/4")

Parts No.	Driver Size	L (mm)	QTY	N.W.	Packaging Illustration
STS-TX-B1-06	TX6	25	6 pcs	32 g	
STS-TX-B1-07	TX7			32 g	
STS-TX-B1-08	TX8			32 g	
STS-TX-B1-09	TX9			32 g	
STS-TX-B1-10	TX10			32 g	
STS-TX-B1-15	TX15			34 g	
STS-TX-B1-20	TX20			34 g	

### 50mm(2")Bits for TORX®

Standard : DIN3126 - C6.3 (1/4")

Parts No.	Driver Size	L (mm)	QTY	N.W.	Packaging Illustration
STS-TX-B2-06	TX6	50	6 pcs	54 g	
STS-TX-B2-07	TX7			54 g	
STS-TX-B2-08	TX8			54 g	
STS-TX-B2-09	TX9			56 g	
STS-TX-B2-10	TX10			58 g	
STS-TX-B2-15	TX15			60 g	
STS-TX-B2-20	TX20			62 g	
STS-TX-B2-25	TX25			62 g	

### 75mm(3")Bits for TORX®

Standard : DIN3126 - E6.3 (1/4")

Parts No.	Driver Size	L (mm)	QTY	N.W.	Packaging Illustration
STS-TX-B3-08	TX8	75	6 pcs	58 g	
STS-TX-B3-09	TX9			64 g	
STS-TX-B3-10	TX10			70 g	
STS-TX-B3-15	TX15			70 g	
STS-TX-B3-20	TX20			78 g	
STS-TX-B3-25	TX25			88 g	

TORX® and TORX PLUS® are registered trademarks of Acument Global Technologies.



# Bits-TORX PLUS®

Hardness : HRC 58° ~ 60°  
Material : High alloy steel

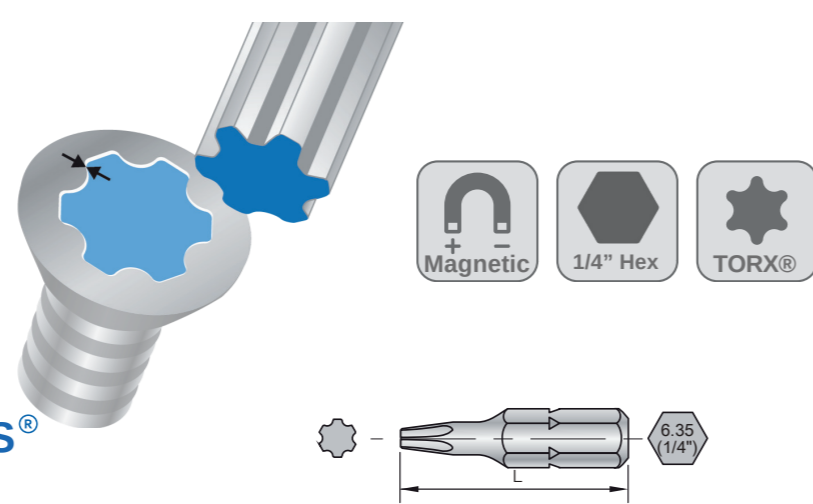

## 25mm(1")Bits for TORX PLUS®

Standard : DIN3126 - C6.3 (1/4")

Parts No.	Driver Size	L (mm)	QTY	N.W.	Packaging Illustration
STS-IP-B1-06	6IP	25	6 pcs	32 g	
STS-IP-B1-07	7IP			32 g	
STS-IP-B1-08	8IP			32 g	
STS-IP-B1-09	9IP			32 g	
STS-IP-B1-10	10IP			32 g	
STS-IP-B1-15	15IP			34 g	
STS-IP-B2-20	20IP			34 g	

## 50mm(2")Bits for TORX PLUS®

Standard : DIN3126 - C6.3 (1/4")

Parts No.	Driver Size	L (mm)	QTY	N.W.	Packaging Illustration
STS-IP-B2-06	6IP	50	6 pcs	54 g	
STS-IP-B2-07	7IP			54 g	
STS-IP-B2-08	8IP			54 g	
STS-IP-B2-09	9IP			56 g	
STS-IP-B2-10	10IP			58 g	
STS-IP-B2-15	15IP			60 g	
STS-IP-B2-20	20IP			62 g	
STS-IP-B2-25	25IP	66 g			

## 75mm(3")Bits for TORX PLUS®

Standard : DIN3126 - E6.3 (1/4")

Parts No.	Driver Size	L (mm)	QTY	N.W.	Packaging Illustration
STS-IP-B3-08	8IP	75	6 pcs	54 g	
STS-IP-B3-09	9IP			66 g	
STS-IP-B3-10	10IP			72 g	
STS-IP-B3-15	15IP			72 g	
STS-IP-B3-20	20IP			78 g	
STS-IP-B3-20	25IP			86 g	

TORX® and TORX PLUS® are registered trademarks of Acument Global Technologies.

# Bits-HEXAGON

Hardness : HRC 58° ~ 60°  
Material : High alloy steel

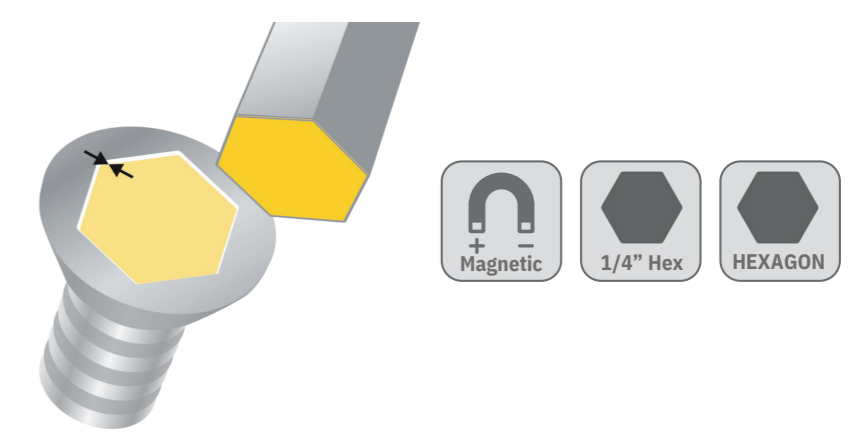

## 25mm(1")Bits for HEXAGON

Standard : DIN3126 - C6.3 (1/4")

Parts No.	Driver Size	H (mm)	G (mm)	L (mm)	QTY	N.W.	Packaging Illustration
STS-HX-B1-1.5	H1.5	1.5	2.3	25	6 pcs	32 g	
STS-HX-B1-2.0	H2.0	2.0	3.0			32 g	
STS-HX-B1-2.5	H2.5	2.5	3.8			33 g	
STS-HX-B1-3.0	H3.0	3.0	4.5			34 g	
STX-HX-B1-4.0	H4.0	4.0	6.0			36 g	
STS-HX-B1-5.0	H5.0	5.0	7.5			40 g	

## 50mm(2")Bits for HEXAGON

Standard : DIN3126 - E6.3 (1/4")

Parts No.	Driver Size	H (mm)	G (mm)	I (mm)	L (mm)	QTY	N.W.	Packaging Illustration
STS-HX-B2-1.5	H1.5	1.5	2.3	25	50	6 pcs	50 g	
STS-HX-B2-2.0	H2.0	2.0	3.0				51 g	
STS-HX-B2-2.5	H2.5	2.5	3.8				54 g	
STS-HX-B2-3.0	H3.0	3.0	4.5				57 g	
STS-HX-B2-4.0	H4.0	4.0	6.0				64 g	
STS-HX-B2-5.0	H5.0	5.0	7.5				72 g	

\*Imperial sized HEXAGON 1" and 2" bits are available on request.

Available sizes are 01/16, 05/64, 03/32, 07/64, 01/08, 09/64, 05/32, 03/16. Part No. STS-HX-B1-XX OR STS-HX-B2-XX



# Pro Station

All-in-One 「TORX® TORX PLUS® HEXAGON」 tools for professional operations

- Cover popular torque from 0.6Nm to 5.5Nm
- A perfect set for every station of the production line



Parts No.	STS-HT-SP- S1
N.W.	1,600g

Handles	Contents									
	Adapters			50mm(2")		50mm(2")		50mm(2")		
	Nm	In-lb	QTY	Size	QTY	Size	QTY	Size	QTY	QTY
STS-IP-HD-S	0.6	5.3	1 pc	TX6	1 pc	6IP	1 pc	H1.5	1 pc	
	0.9	8.0		TX7		7IP		-		
1.2	10.6	TX8		8IP		H2.0				
STS-IP-LT	1.4	12.4		TX9		9IP		-		
	2.0	17.7		TX10		10IP		H2.5		
STS-IP-ST	3.0	26.6		TX15		15IP		H3.0		
	5.0	44.3		TX20		20IP		H4.0		
	5.5	48.7		TX25		25IP		H5.0		

# Work Station

「TORX® or TORX PLUS®」 Tools For long time uses and storage

## Torque Screwdriver Set for TORX®, 25mm+50mm Bits

Parts No.	Contents						N.W.	Packaging Illustration
	Handles	Adapters			Bits			
		Size	Nm	In-lb	25mm(1")	50mm(2")		
STS-TX-HL-S4	STS-TX-HD-S	TX6	0.6	5.3	1 pc + 1 pc	855g		
		TX7	0.9	8.0				
		TX8	1.2	10.6				
	STS-TX-LT	TX9	1.4	12.4				
		TX10	2.0	17.7				
		TX15	3.0	26.6				

\*Work Station for TORX PLUS® is available on request, Part No. STS-IP-HL-S4.

# Pro Set

All-in-One 「TORX® TORX PLUS® HEXAGON」 tools for professional operations

- Easy to store and pick up all-in-one set without the bulk of the stand.
- Cover popular torque from 0.6Nm to 5.0Nm



Parts No.	STS-XX-S17
N.W.	700g

Handles	Contents									
	Adapters			50mm(2")		50mm(2")		50mm(2")		
	Nm	In-lb	QTY	Size	QTY	Size	QTY	Size	QTY	QTY
STS-TX-HD-S	0.6	5.3	1 pc	TX6	1 pc	6IP	1 pc	-	-	-
	0.9	8.0		TX7		7IP		-		
1.2	10.6	TX8		8IP		H2.0		1 pc		
STS-TX-LT	1.4	12.4		TX9		9IP		-		
	2.0	17.7		TX10		10IP		H2.5		
STS-TX-ST	3.0	26.6		TX15		15IP		H3.0		1 pc
	5.0	44.3		TX20		20IP		H4.0		
				TX25		25IP		-		

# Combo Set

## All-in-One TORX® Set, 25mm(1") Bits+ 50mm (2") Bits

Parts No.	Contents						N.W.	Packaging Illustration
	Handles	Adapters			Bits			
		Size	Nm	In-lb	25mm(1")	50mm(2")		
STS-TX-LT- S1	STS-TX-HD-S	TX6	0.6	5.3	1 pc + 1 pc	780g		
		TX8	1.2	10.6				
		TX9	1.4	12.4				
	STS-TX-LT	TX10	2.0	17.7				
		TX15	3.0	26.6				
		STS-TX-ST	TX20	5.0				44.3
		TX25	5.5	48.7				

\*Combo Set for TORX PLUS® is available on request, Part No. STS-IP-BG-S1.

\*Combo Set for HEXAGON is available on request, Part No. STS-HX-BG-S1.

# Smart Set

Covers 0.6Nm to 3.0Nm adapters with one universal handle.

## Torque Screwdriver Kit for TORX®, 25mm (1") Bits

Parts No.	Contents					N.W.	Packaging Illustration
	Handles	Adapters			Bits		
		Size	Nm	In-lb	25mm(1")		
STS-TX-LT-S1	STS-TX-LT	TX6	0.6	5.3	1 pc	290g	
		TX7	0.9	8.0			
		TX8	1.2	10.6			
		TX9	1.4	12.4			
		TX10	2.0	17.7			
		TX15	3.0	26.6			



## Torque Screwdriver Kit for TORX PLUS®, 25mm (1") Bits

Parts No.	Contents					N.W.	Packaging Illustration
	Handles	Adapters			Bits		
		Size	Nm	In-lb	25mm(1")		
STS-IP-LT-S1	STS-IP-LT	TX6	0.6	5.3	1 pc	290g	
		TX7	0.9	8.0			
		TX8	1.2	10.6			
		TX9	1.4	12.4			
		TX10	2.0	17.7			
		TX15	3.0	26.6			



# Twin Set



Most popular torque settings ready to go.

## Torque Screwdriver Set for TORX®, 25mm(1")+50mm(2") Bits

Parts No.	Contents					N.W.	Packaging Illustration
	Handles	Adapters			Bits		
		Size	Nm	In-lb	25mm(1") 50mm(2")		
STS-TX-TW-S1	STS-TX-HD-S	TX6	0.6	5.3	1 pc + 1 pc	445g	
		TX7	0.9	8.0			
		TX8	1.2	10.6			
	STS-TX-LT	TX9	1.4	12.4			
		TX10	2.0	17.7			
		TX15	3.0	26.6			

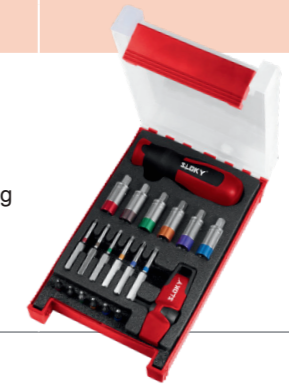

## Torque Screwdriver Set for TORX PLUS®, 25mm(1")+50mm(2") Bits

Parts No.	Contents					N.W.	Packaging Illustration
	Handles	Adapters			Bits		
		Size	Nm	In-lb	25mm(1") 50mm(2")		
STS-IP-TW-S1	STS-IP-HD-S	6IP	0.6	5.3	1 pc + 1 pc	445g	
		7IP	0.9	8.0			
		8IP	1.2	10.6			
	STS-IP-LT	9IP	1.4	12.4			
		10IP	2.0	17.7			
		15IP	3.0	26.6			



## Torque Screwdriver Set for HEXAGON, 25mm (1")+50mm(2") Bits

Parts No.	Contents					N.W.	Packaging Illustration
	Handles	Adapters			Bits		
		Size	Nm	In-lb	25mm(1") 50mm(2")		
TSD-10-HX	STS-TX-HD-S	H1.5	0.6	5.3	1 pc + 1 pc	445g	
		H2.0	1.2	10.6			
		H2.5	2.0	17.7			
	STS-TX-LT	H3.0	3.0	26.6			
		H4.0	5.0	44.3			
		H5.0	5.5	48.7			



TORX® and TORX PLUS® are registered trademarks of Acument Global Technologies.



# Single Set | Economical Starter Set

## ■ HD Single Set(HD), LT Single Set(LT), ST Single Set(ST) for TORX®.

Parts No.	Contents					N.W.	Packaging Illustration	
	Handles	Adapters			Bits 25mm(1") 50mm(2")			
		Size	Nm	In-lb				
STS-TX-HD-06	STS-TX-HD-S	TX6	0.6	5.3	1 pc+1pc	150g		
STS-TX-HD-07		TX7	0.9	8.0				
STS-TX-HD-08		TX8	1.2	10.6				
STS-TX-HD-09		TX9	1.4	12.4				
STS-TX-HD-10		TX10	2.0	17.7				
STS-TX-HD-15		TX15	3.0	26.6				
STS-TX-LT-06	STS-TX-LT	TX6	0.6	5.3	2 pc+2 pc	135g		
STS-TX-LT-07		TX7	0.9	8.0				
STS-TX-LT-08		TX8	1.2	10.6				
STS-TX-LT-09		TX9	1.4	12.4				
STS-TX-LT-10		TX10	2.0	17.7				
STS-TX-LT-15		TX15	3.0	26.6				
STS-TX-ST-10	STS-TX-ST	TX10	2.0	17.7	Bits 50mm (2")	2 pc+2 pc	200g	
STS-TX-ST-15		TX15	3.0	26.6				
STS-TX-ST-20		TX20	5.0	44.3				
STS-TX-ST-25		TX25	5.5	48.7				

\*HD Single Set(HD) for TORX PLUS® is available on request, Part No. STS-IP-HD-XX.

\*LT Single Set(LT) for TORX PLUS® is available on request, Part No. STS-IP-LT-XX.

\*ST Single Set(ST) for TORX PLUS® is available on request, Part No. STS-IP-ST-XX.

# Single Set | Economical Starter Set

## ■ HD Single Set(HD), LT Single Set(LT), ST Single Set for HEXAGON.

Parts No.	Contents					N.W.	Packaging Illustration	
	Handles	Adapters			Bits 25mm(1") 50mm(2")			
		Size	Nm	In-lb				
STS-HX-HD-1.5	STS-HD-LT	TX7	0.9	8.0	1 pc+1pc	150g		
STS-HX-HD-2.0		TX8	1.2	10.6				
STS-HX-HD-2.5		TX10	2.0	17.7				
STS-HX-HD-3.0		TX15	3.0	26.6				
STS-HX-HD-01/16		1/16"	0.9	8.0				
STS-HX-HD-05/64		5/64"	1.4	12.4				
STS-HX-HD-03/32		3/32"	0.6	5.3				
STS-HX-HD-07/64		7/64"	2.0	17.7				
STS-HX-HD-01/8		1/8"	3.0	26.6				
STS-HX-LT-1.5		STS-HD-LT	TX7	0.9				8.0
STS-HX-LT-2.0	TX8		1.2	10.6				
STS-HX-LT-2.5	TX10		2.0	17.7				
STS-HX-LT-3.0	TX15		3.0	26.6				
STS-HX-LT-01/16	1/16"		0.9	8.0				
STS-HX-LT-05/64	5/64"		1.4	12.4				
STS-HX-LT-03/32	3/32"		0.6	5.3				
STS-HX-LT-07/64	7/64"		2.0	17.7				
STS-HX-LT-01/8	1/8"		3.0	26.6				
STS-HX-ST-4.0	STS-HD-LT		H4.0	5.0	44.5	Bits 50mm (2")	4 pcs	200g
STS-HX-ST-5.0		H5.0	5.5	48.7				
STS-HX-ST-09/64		9/64"	5.0	44.5				
STS-HX-ST-05/32		5/32"	5.0	44.5				
STS-HX-ST-03/16		3/16"	5.5	48.7				



# Information



## IMPORTANT

Do not use SLOKY to loosen screws tightened with unknown torque settings. View the product's user manual for the targeted torque settings.

### Features of the different handles

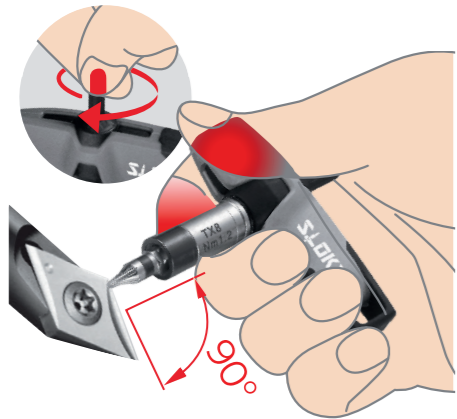

The flag-shaped T handles are ergonomically designed for quick tightening and loosening with lower torques. Use the shaft at the top for quick turning. Best for torque setting between 2- 5.5Nm.



The straight handles are designed to fit snugly in your hands. The straight fit has no leverage against high torques. But benefit greatly with smaller torques because stripping the screws won't be a concern.



The heavy-duty T handles are designed for high torque operations. The larger T-shape provides the best leverage, fit in your whole hands, and is energy-efficient with middle and large torque settings.

# Digital Media

Website



Youtube



Instagram



Contact us



**CUSTOMED DESIGN**  
**MEDICAL**  
**AEROSPACE**  
**CNC/PRECISION MACHINING**  
**CYCLING**  
**MICROELECTRONICS**  
**DIYS**



**SLOKY<sup>®</sup>**  
**Smart Torque**  
**Everywhere**  
**Possible**